

LEGEND

	EXISTING	PROPOSED
SURFACE LEVEL	EST12.80	FS112.83
CONTOUR	-111.25	-111.25
STORMWATER PIPE		
STABILISED SAND BACKFILL		
STORMWATER PIT		
KERB AND CHANNEL		
SEMI MOUNTABLE KERB		
FLUSH KERB		
VEHICLE CROSSING (PREFERRED)		
POWER/SERVICE PIT		
UNDERGROUND POWER		
TELECOM'S PIT		
TELECOM'S CABLE		
SEWER MAIN		
WATER MAIN / FIREPLUG		
HOUSE DRAINAGE BLOCK		
PERMANENT SURVEY MARK		
PIT No.		①
DIRECTION OF STORMWATER RUNOFF		→
CUT ON ALLOTMENTS		
FILL ON ALLOTMENTS IN EXCESS OF 300mm		

COMPACTION REQUIREMENT ON ALLOTMENTS

COMPACTION	MOISTURE CONTROL
95% STANDARD (min)	± 2% OPTIMUM

1. PLEASE NOTE THAT CLAY FILLING SHALL STOP AT FSL -50mm

APPROX 1% FLOOD LEVEL 111.55

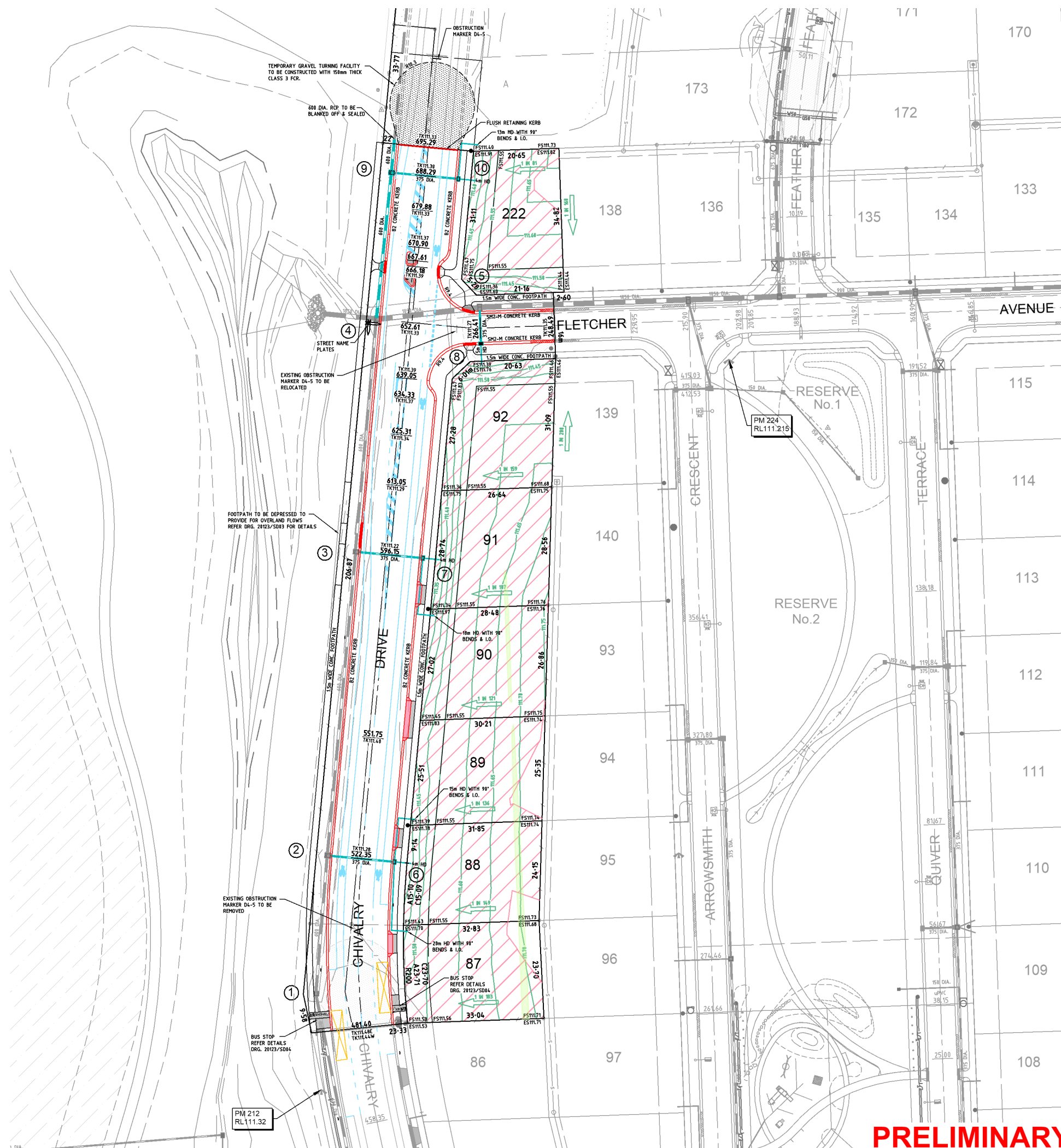

REVISION	DATE

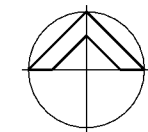

0 5 10 20m

Scale 1 : 500 @ A1

Chris Smith & ASSOCIATES PTY LTD

· CIVIL ENGINEERS · URBAN & REGIONAL PLANNERS · LAND SURVEYORS · PROJECT MANAGERS
 LEVEL 1 / 135 FRYERS STREET, SHEPPARTON, VIC. 3630
 PH: (03) 5820 7700 FAX: (03) 5822 4878 www.csmith.com.au

Designed Lisa Stevens August 2020
 Drawn Lisa Stevens September 2020
 Checked Chris Mephem September 2020
 Approved

Waranga Pty. Ltd.
Park Views Estate - Stage 7A
 (Formerly Archer's Field Estate)
 Chivalry Drive, Mooroopna
Street & Drainage Construction
Layout Plan
 Drawing No. 20123/SD02 Rev. -
 Sheet No. 2 of 14 20123 SD02v0.dwg

PRELIMINARY

Chris Smith & Associates ABN 14 627 882 064
 THIS DOCUMENT IS COPYRIGHT AND MAY ONLY BE USED FOR THE PURPOSE FOR WHICH IT WAS COMMISSIONED. UNAUTHORISED USE PROHIBITED. ALL DIMENSIONS AND LEVELS TO BE CHECKED ON THE PROJECT BEFORE COMMENCING ANY WORKS OR SHOP DRAWINGS. DRAWINGS NOT TO BE SCALED.