

COMPACTION REQUIREMENT ON ALLOTMENTS

COMPACTION	MOISTURE CONTROL
95% STANDARD (min)	± 2% OPTIMUM

1. PLEASE NOTE THAT CLAY FILLING SHALL STOP AT FSL -50mm

APPROX 1% FLOOD LEVEL 111.55

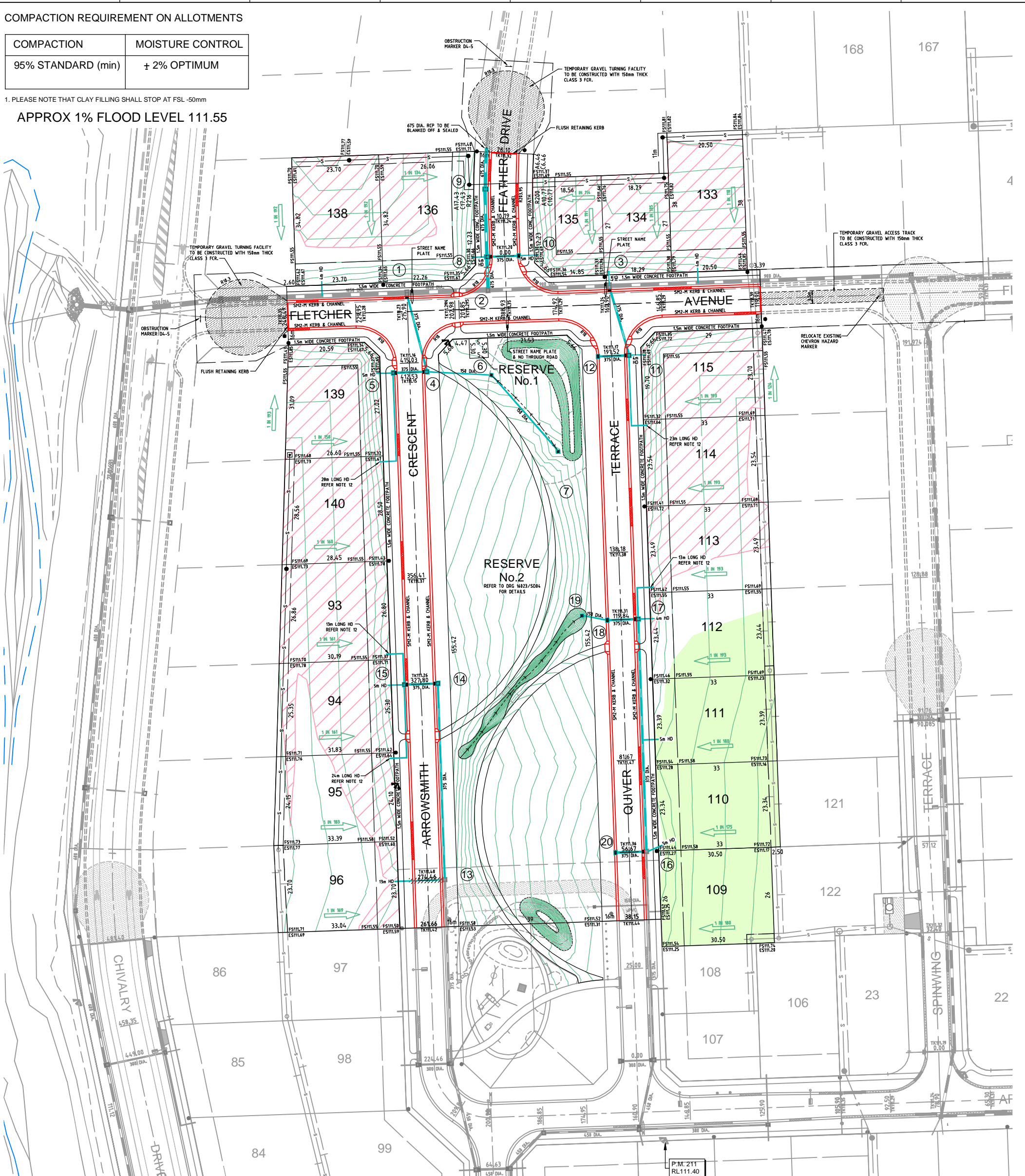

	EXISTING	PROPOSED		EXISTING	PROPOSED
SURFACE LEVEL	EST11.88	FS111.83	TELSTRA PIT	■	■
CONTOUR	—	—	TELSTRA CABLE	—	—
STORMWATER PIPE	—	—	TELSTRA CONDUIT	—	—
STABILISED SAND BACKFILL	—	—	SEWER MAIN	—	—
STORMWATER PIT	■	■	HOUSE DRAINAGE BLOCK	—	—
ROLLOVER KERB	—	—	PERMANENT SURVEY MARK	—	—
KERB AND CHANNEL	—	—	PIT No.	①	①
VEHICLE CROSSING M2	—	—	DIRECTION OF STORMWATER RUNOFF	→	→
VEHICLE CROSSING (PREFERRED)	—	—	CUT ON ALLOTMENTS & RESERVE	—	—
POWER/SERVICE PIT	●	●	FILL ON ALLOTMENTS IN EXCESS OF 300mm (INCLUDES 80mm TOPSOIL STRIP)	■	■
UNDERGROUND POWER	—	—			
WATER MAIN	—	—			
FIREPLUG	—	—			

- GENERAL NOTES :
- UNLESS NOTED OTHERWISE ALL HOUSE DRAINS TO BE 150mm DIA. uPVC EXTENDING 1m INTO LOT, REFER TO STANDARD CONSTRUCTION DETAILS DRG. No. 16023/S018. UNLESS NOTED OTHERWISE ALL HOUSE DRAINS AT LOT BOUNDARIES TO BE TYPICALLY LOCATED 1.5m FROM BOUNDARY AND 7m FROM LOT BOUNDARY WHERE SHOWN MORE CENTRAL TO THE LOT.
  - ALL DRAINAGE PIPES TO BE CLASS "2" RUBBER RING JOINTED REINFORCED CONCRETE UNLESS NOTED OTHERWISE.
  - BACKFILL FOR STORMWATER PIPES UNDER ROAD PAVEMENT AND FOOTPATH TO BE CLASS 3 F.G.R. COMPACTED IN 150mm LAYERS.
  - UNLESS NOTED OTHERWISE RUNNING DISTANCES SHOWN REFER TO CENTRELINE OF ROAD.
  - RADIUS REFER TO BACK OF KERB.
  - THE CONTRACTOR SHALL CONFIRM CONDUIT LOCATION PRIOR TO EXCAVATION AND PLACEMENT.
  - FILL TO EXTEND 0.5m BEYOND TITLE BOUNDARY BEFORE BATTERING AT 1 IN 2 TO MATCH EXISTING SURFACE LEVELS. UNLESS OTHERWISE SHOWN.
  - WHEN SETTING OUT FOR BEHIND KERB DRAINAGE CONSTRUCTION THE CONTRACTOR MUST MAKE THE APPROPRIATE ALLOWANCE FOR THE PROPOSED TRENCH WIDTH, IN ORDER TO ENSURE THAT THE EDGE OF THE TRENCH HAS A MINIMUM CLEARANCE OF 150mm FROM THE BACK OF KERB.
  - WHEN CONSTRUCTING JUNCTION PITS BEHIND KERB THE CONTRACTOR SHALL MAKE THE APPROPRIATE ALLOWANCE FOR THE PASSAGE OF THE KERB MACHINE.
  - ALL PRAM CROSSINGS TO HAVE ZERO BULLNOSE.
  - ALL LEVELS ARE TO A.H.D. AND BASED ON PM No.191 RL 111.541 AT THE INTERSECTION OF KALINDA DRIVE AND WINDLASS AVENUE.
  - HOUSE DRAIN FOR LOT No's 93, 95, 113, 114 AND 140 TO BE 150 DIA. uPVC SEWER GRADE STORMWATER PIPE WITH A 90° AND A 150 DIA. INSPECTION OPENING.
  - THE LOCATION OF EXISTING UNDERGROUND SERVICES ARE APPROXIMATE ONLY AND THEIR EXACT POSITION AND LEVEL SHOULD BE PROVEN ON SITE PRIOR TO COMMENCEMENT OF ANY WORKS.
  - IN CONSTRUCTION OF PSM'S THE CONTRACTOR SHALL NOTIFY THE SUPERINTENDENT WITH A MINIMUM OF 24 HOURS NOTICE PRIOR TO COMMENCING WORK. AND THE CONCRETE BLOCK SHALL NOT BE POURED UNTIL THE CAVITY HAS BEEN VIEWED BY THE SUPERINTENDENT.
  - ALL STORMWATER DRAINAGE TRENCHES TO BE COMPACTED TO ACHIEVE AT LEAST 95% STANDARD COMPACTION UNLESS OTHERWISE NOTED.
  - STREET NAME PLATES TO BE INSTALLED WITH ANTI-VANDAL CONNECTIONS. www.advanceroadsigns.com.au/Brochures\_Posts\_Standards/13.htm#BrocSt REFER TO THE ABOVE WEB SITE FOR DETAILS OF ANTI-VANDAL BOLTS.
  - VEHICLE CROSSINGS SHOWN WITHIN THE SM2-M (MODIFIED) KERB PROFILE ARE PREFERRED LOCATIONS ONLY. THE MODIFIED PROFILE SPECIFIED ALLOWS CONTINUOUS VEHICLE ACCESS BUT CONSIDERATION OF SERVICE LOCATIONS MUST BE TAKEN INTO ACCOUNT WHEN DRIVEWAYS ARE TO BE CONSTRUCTED AT A LOCATION OTHER THAN HAS BEEN NOMINATED ON THE PLANS.

**PRELIMINARY**

REVISION	DATE	ZONE

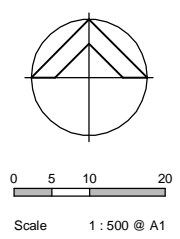

**Chris Smith & Associates**  
 PTY LTD  
 SPECIALISING IN SUBDIVISION PROJECT MANAGEMENT AND DESIGN  
 11 EDWARD STREET, SHEPPARTON PH. (03)58207 700 FAX. (03)5822 4878  
 Designed Lisa Stevens August 2016  
 Drawn Lisa Stevens September 2016  
 Checked Chris Mepham October 2016  
 Approved

**Waranga Pty. Ltd.**  
 Archer's Field Estate - Stage 6  
 Fletcher Avenue, Mooroopna  
**Street & Drainage Construction**  
 Layout Plan  
 Drawing No. 16023/S020 Rev. -  
 Sheet No. 2 of 18 16023 SD02.v.01  
 © Chris Smith & Associates ABN 14 627 882 064