

# Tatura Waters

**STAGE 3 - NOW SELLING**



**YOUNGS & CO**  
REAL ESTATE



☒ **CONTACT:**  
**GLENN YOUNG**  
**CALL: 0438 579 993**

 **SHEPPARTON: CALL: 03 5820 8777**  
 **MOOROOPNA: CALL: 03 5825 4833**

[YOUNGSANDCO.COM.AU](http://YOUNGSANDCO.COM.AU)

**TALK TO A  
LOCAL**

**YOUNGS & CO**  
REAL ESTATE





## STAGE 3 – LARGE 2,000m<sup>2</sup> BLOCKS

These highly sought after large, fully serviced residential blocks are positioned off Ferguson Road and are right on the edge of town with full services + a raw water supply!

**Contact Glenn Young 0438579993 for further details**

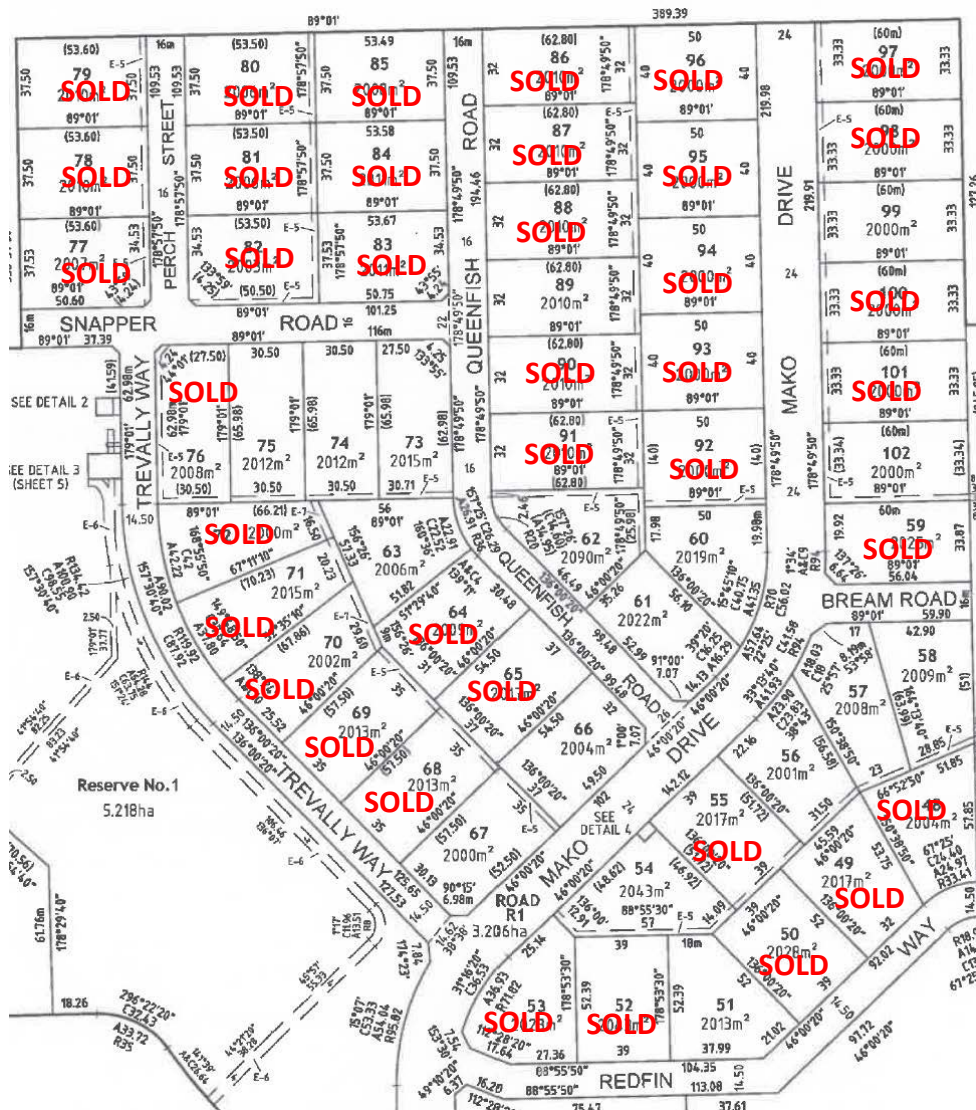

LOT	PRICE
51	\$303,500
54	\$298,500
56	\$298,500
57	\$298,500
58	\$298,500
60	\$298,500
61	\$298,500
62	\$298,500
63	\$298,500
66	\$298,500
67	\$303,500
73	\$298,500
74	\$298,500
75	\$298,500
89	\$298,500
99	\$298,500
102	\$298,500

PRICED FROM

# 298,500

☒ CONTACT:  
GLENN YOUNG  
CALL: 0438 579 993

SHEPPARTON: CALL: 03 5820 8777  
MOORoopNA: CALL: 03 5825 4833

YOUNGSANDCO.COM.AU



**YOUNGS & CO**  
REAL ESTATE

