

WARNING

BEWARE OF UNDERGROUND SERVICES

THE LOCATIONS OF UNDERGROUND SERVICES ARE APPROXIMATE ONLY AND THEIR EXACT POSITION SHOULD BE PROVEN ON SITE. NO GUARANTEE IS GIVEN THAT ALL EXISTING SERVICES ARE SHOWN.

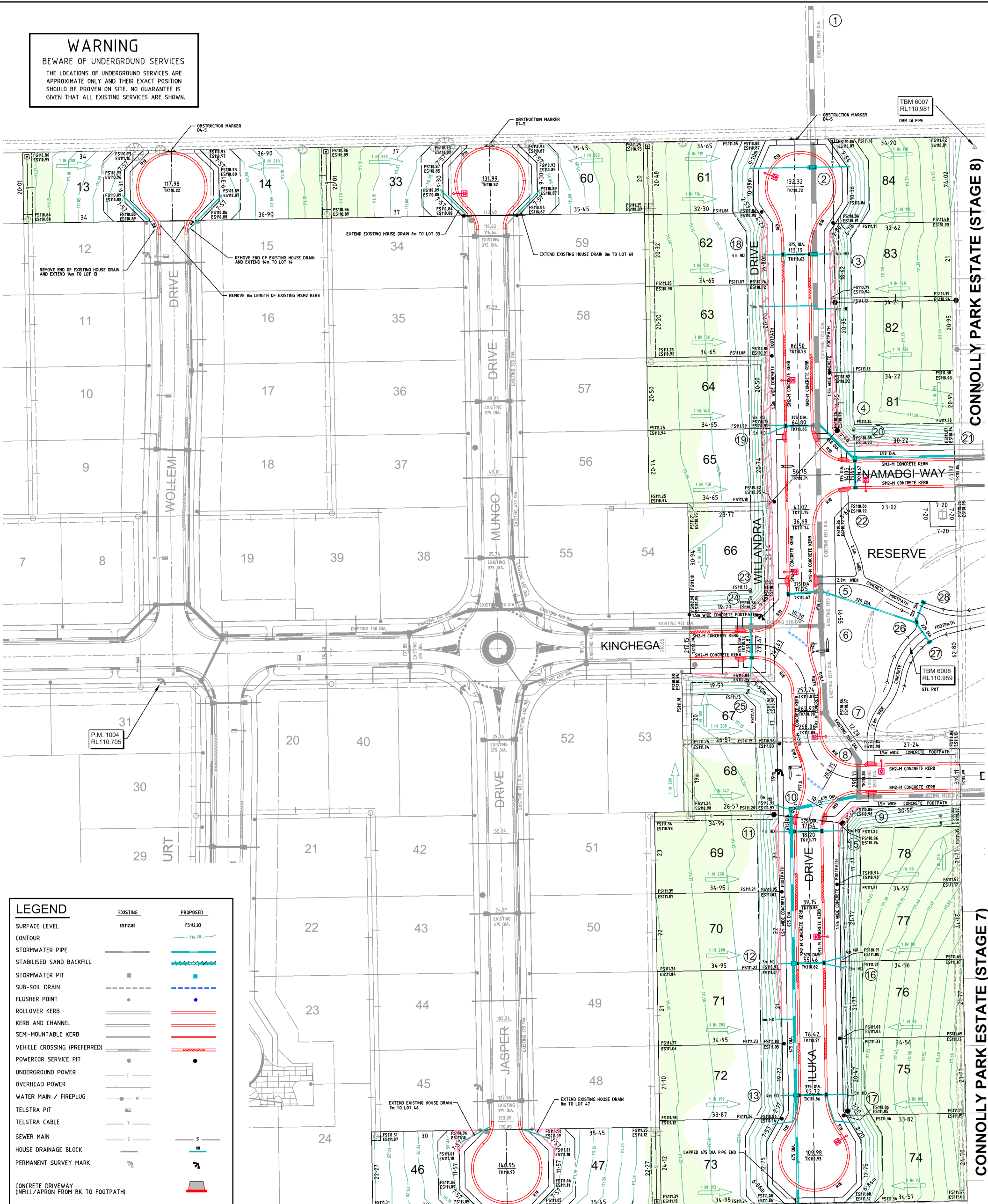

CONNOLLY PARK ESTATE (STAGE 8)

CONNOLLY PARK ESTATE (STAGE 7)

LEGEND

	EXISTING	PROPOSED
SURFACE LEVEL	ES112.88	FS112.83
CONTOUR	-	1:14.20
STORMWATER PIPE	-	Blue line with 'S'
STABILISED SAND BACKFILL	-	Blue hatched area
STORMWATER PIT	-	Blue square
SUB-SOIL DRAIN	-	Blue dashed line
FLUSHER POINT	-	Blue circle
ROLLOVER KERB	-	Red double line
KERB AND CHANNEL	-	Red double line with 'K'
SEMI-MOUNTABLE KERB	-	Red double line with 'S'
VEHICLE CROSSING (PREFERRED)	-	Red double line with 'V'
POWERCOR SERVICE PIT	-	Black circle
UNDERGROUND POWER	-	Red line with 'U'
OVERHEAD POWER	-	Red line with 'O'
WATER MAIN / FIREPLUG	-	Red line with 'W'
TELSTRA PIT	-	Black square
TELSTRA CABLE	-	Red line with 'T'
SEWER MAIN	-	Red line with 'S'
HOUSE DRAINAGE BLOCK	-	Red line with 'H'
PERMANENT SURVEY MARK	-	Black circle with 'S'
CONCRETE DRIVEWAY (INFILL/APRON FROM BK TO FOOTPATH)	-	Red hatched area
PIT No.	-	Circle with number
DIRECTION OF STORMWATER RUNOFF	-	Green arrow
CUT ON ALLOTMENTS & RESERVE	-	Red hatched area
FILL ON ALLOTMENTS & RESERVE IN EXCESS OF 300mm	-	Green hatched area
EXISTING TREE TO REMAIN	-	Green tree symbol
EXISTING TREE TO BE REMOVED	-	Red tree symbol

COMPACTION REQUIREMENT FOR ROAD SUB-GRADE FILLING

COMPACTION	MOISTURE CONTROL
98% STANDARD (min)	± 2% OPTIMUM

NOTE:
 1. FILLING SHALL BE PLACED AND COMPACTED IN 150mm LAYERS.
 2. ROAD SUB-GRADE FILLING TO UNDERSIDE OF LOWER SUB-GRADE TO HAVE 3 TESTS PER LAYER. EACH LAYER TO ACHIEVE MEAN GREATER THAN 98% WITH NO INDIVIDUAL RESULT LESS THAN 97%.

COMPACTION REQUIREMENT ON RESIDENTIAL ALLOTMENTS

FILLING ZONE	COMPACTION	MOISTURE CONTROL
BOTTOM i.e. FROM STRIPPED SURFACE UP TO 200mm BELOW FSL	95% STANDARD (min)	± 2% OPTIMUM
TOP i.e. FROM 200mm BELOW F.S.L. UP TO 50mm BELOW FSL	90% STANDARD (min)	NOT SPECIFIED

1. PLEASE NOTE THAT CLAY FILLING SHALL STOP AT FSL -50mm

REVISION	DATE	ZONE

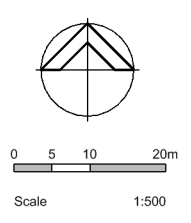

Chris Smith & ASSOCIATES
 PTY LTD
 CIVIL ENGINEERS · URBAN & REGIONAL PLANNERS · LAND SURVEYORS · PROJECT MANAGERS
 LEVEL 1 / 135 FRYERS STREET, SHEPPARTON, VIC. 3630
 PH: (03) 5820 7700 FAX: (03) 5822 4878 www.csmith.com.au

Designed Mark McDonald October 2017
 Drawn Mark McDonald October 2017
 Checked Chris Mepham February 2018
 Approved

Kavant Management P/L
Northside Estate - Stage 3
 380 - 390 Goulburn Valley Highway, Shepparton

Street & Drainage Construction
Layout Plan
Drawing No. 17062/SD04 Rev. 0
 Sheet No. 4 of 22 17062_SD03r0.dwg
 © Chris Smith & Associates ABN 14 627 882 064 A1