

NOTE:
REFER TO DRG. 17124/SD03 FOR DETAILS OF
WORKS REQUIRED NORTH OF CH 1.14

- EXISTING CONCRETE KERB TO BE DEMOLISHED AND REMOVED FROM CH1.04
- EXISTING ASPHALT SURFACE TO BE PROFILED FOR RE-SHEETING (MIN. DEPTH 30mm)
- FULL WIDTH PAVEMENT RECONSTRUCTION FROM CH1.57
- EXISTING CONCRETE KERB TO BE DEMOLISHED AND REMOVED FROM CH1.57
- EXISTING CONCRETE DRIVEWAY TO BE DEMOLISHED, REMOVED AND RECONSTRUCTED.
- EXISTING CONCRETE INFILL AT BLISTER TO BE DEMOLISHED & REMOVED.

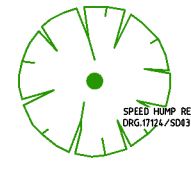

NOTE:
SHARED PATH TO BE EXTENDED THROUGH COUNCIL'S RESERVE AND BOLLARDS OR SIMILAR TO BE INSTALLED ALONG THE WEST SIDE OF LOMANDRA DRIVE AS PART OF THE LANDSCAPE / PLAYGROUND WORKS.

TRANSITION FROM M3 REVERSE KERB PROFILE TO SM2-M

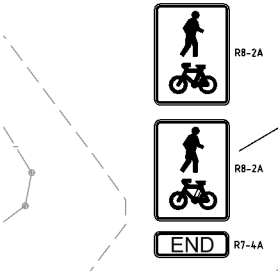

TRANSITION FROM M3 REVERSE KERB PROFILE TO SM2-M

TRANSITION FROM M3 REVERSE KERB PROFILE TO SM2-M

TRANSITION FROM M3 REVERSE KERB PROFILE TO SM2-M

TRANSITION FROM M3 REVERSE KERB PROFILE TO SM2-M

TRANSITION FROM M3 REVERSE KERB PROFILE TO SM2-M

TRANSITION FROM M3 REVERSE KERB PROFILE TO SM2-M

TRANSITION FROM M3 REVERSE KERB PROFILE TO SM2-M

TRANSITION FROM M3 REVERSE KERB PROFILE TO SM2-M

TRANSITION FROM M3 REVERSE KERB PROFILE TO SM2-M

TRANSITION FROM M3 REVERSE KERB PROFILE TO SM2-M

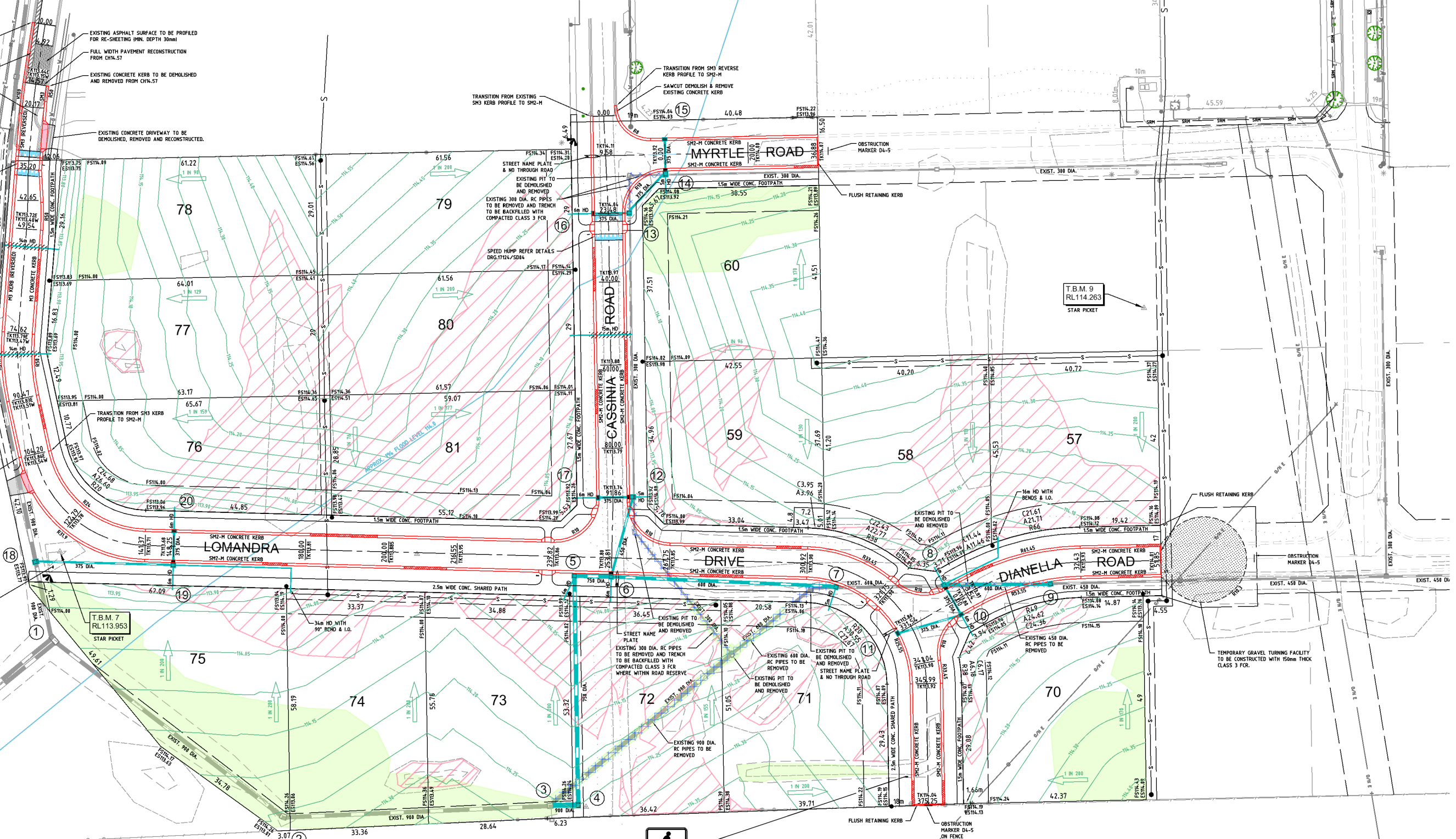

LEGEND		EXISTING	PROPOSED	EXISTING	PROPOSED	EXISTING	PROPOSED
SURFACE LEVEL		E5375.25	F5374.93	POWERCOR SERVICE PIT		●	●
CONTOUR		114.85	114.85	OVERHEAD POWER		OH / E	
STORMWATER PIPE		---	---	TELECO PIT		□	
STABILISED SAND BACKFILL		---	---	TELECO CABLE		---	
STORMWATER PIT		■	■	SEWER MAIN		S	S
HOUSE DRAINAGE		---	---	WATER MAIN / FIREPLUG		W	W
MODIFIED KERB SM2-M		---	---	GAS MAIN		G	G
VEHICLE CROSSING (PREFERRED)		---	---	PERMANENT SURVEY MARK		▲	▲
				PIT No.		①	①
				DIRECTION OF STORMWATER RUNOFF		→	→
				CUT ON ALLOTMENTS		▨	▨
				FILL ON ALLOTMENTS IN EXCESS OF 300mm		■	■
				EXISTING TREE TO BE REMOVED		⊗	⊗
				EXISTING TREE TO REMAIN		⊙	⊙

REVISION	DATE	ZONE
5 POWERCOR KIOSK RESERVE SIZE ENLARGED	22/06/2018	
4 SPEED HUMP ADDED IN CASSINIA RD. & EASTERN FOOTPATH REMOVED AND NORTHERN FOOTPATH IN MYRTLE RD. REMOVED	10/04/2018	
3 POWERCOR KIOSK RESERVE RELOCATED TO LOT 59	15/03/2018	
2 CONCRETE DRIVEWAY ACCESS TO COUNCIL RESERVE ADDED	13/03/2018	
1 TRAFFIC CALMING ADDED, DRAINAGE ALTERED ETC.	08/03/2018	

NOTE!
BEWARE OF EXISTING
OVERHEAD POWER CABLES.

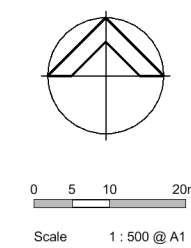

Chris Smith & ASSOCIATES
PTY LTD
SPECIALISING IN SUBDIVISION PROJECT MANAGEMENT AND DESIGN
LEVEL 1 / 135 FRYERS STREET, SHEPPARTON, VIC. 3630
PH: (03) 5820 7700 FAX: (03) 5822 4878 www.csmith.com.au

Designed: Lisa Stevens December 2017
Drawn: Lisa Stevens January 2018
Checked: Chris Mepham February 2018
Approved:

Mawquip Pty. Ltd.
Riviera Park Estate - Stage 3
Lomandra Drive, Kialla

Street & Drainage Construction
Layout Plan
Drawing No. 17124/SD02 Rev. 5
Sheet No. 2 of 18 17124 SD02v2.dwg

© Chris Smith & Associates ABN 14 627 862 064 A1
THIS DOCUMENT IS COPYRIGHTED AND MAY ONLY BE USED FOR THE PURPOSE FOR WHICH IT WAS COMMISSIONED. UNAUTHORISED USE IS PROHIBITED. ALL DIMENSIONS AND LEVELS TO BE CHECKED ON THE PROJECT BEFORE COMMENCING ANY WORKS OR SHOP DRAWINGS. DRAWINGS NOT TO BE SCALED.