



Shepparton's  
premier new estate...



# GRAMMAR PARK GARDENS

The best of family living...



Shepparton's  
premier  
address with  
lots of wide  
open space

Featuring large blocks perfect for fun with the family

Growing on the popularity and prestige of one of Shepparton's most popular lifestyle estates, Grammar Park, the brand new Grammar Park Gardens Estate is the latest offering, providing families the opportunity to enjoy a premier lifestyle.

The master planned Grammar Park Gardens Estate is the natural continuation of Grammar Park, extending West and bridging the gap from Verney Road to the Goulburn Valley Highway, providing a long awaited direct link from the popular arterial road.

Within 10 minutes of the CBD and close to sporting precincts, supermarket, retail, hospital and some of the regions most premier schools

Shepparton's North is one of the most popular growth areas for the region. With it's close proximity to respected schools such as Goulburn Valley Grammar School and St Luke's Catholic Primary School as well as major sporting facilities, Goulburn Valley Health and the Rural School of Medicine, not to mention shopping, with new proposed shopping developments already in the planning stages and only minutes from the regions major Shopping precincts.

TALK TO A  
**LOCAL**

SHEPPARTON CALL: 03 5820 8777  
MOOROOPNA CALL: 03 5825 4833

[WWW.YOUNGSANDCO.COM.AU](http://WWW.YOUNGSANDCO.COM.AU)

**YOUNGS & CO**  
REAL ESTATE



Contact: Glenn Young 0438 579 993



# GRAMMAR PARK GARDENS

The best of family living...

## STAGE 9 – Now Selling!!!

MGA94 ZONE 55

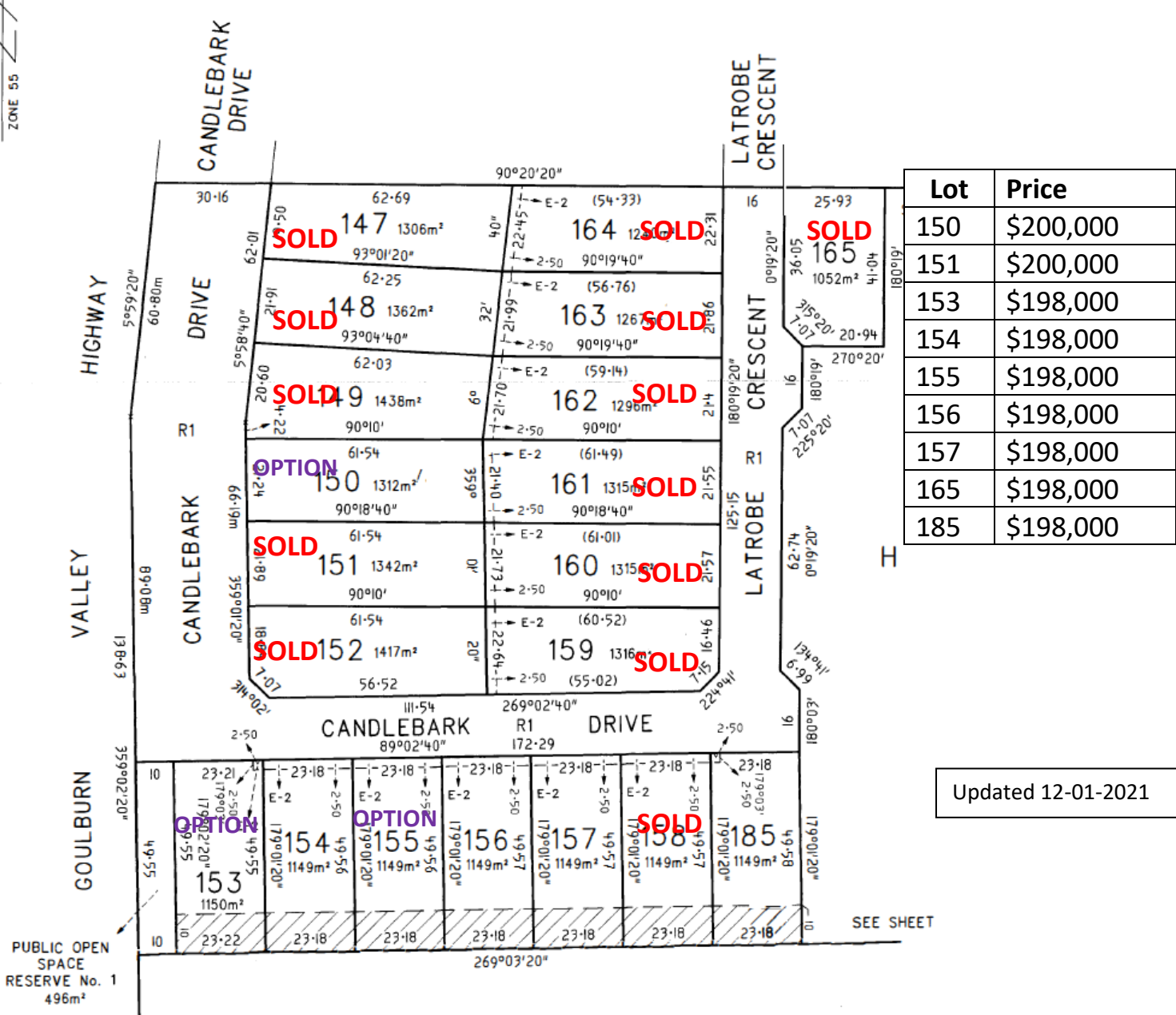

Lot	Price
150	\$200,000
151	\$200,000
153	\$198,000
154	\$198,000
155	\$198,000
156	\$198,000
157	\$198,000
165	\$198,000
185	\$198,000

Updated 12-01-2021

**TALK TO A LOCAL**

SHEPPARTON CALL: 03 5820 8777  
 MOOROOPNA CALL: 03 5825 4833  
 WWW.YOUNGSANDCO.COM.AU

**YOUNGS & CO**  
 REAL ESTATE

Contact: Glenn Young 0438 579 993